

# Soils Map

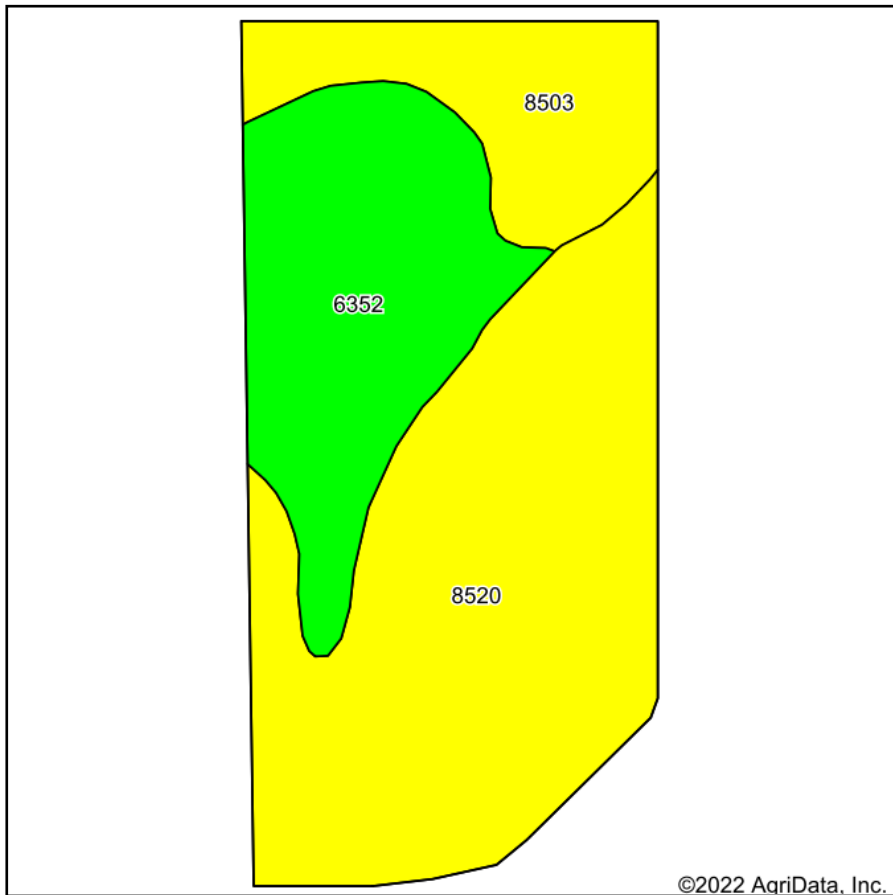

Soils data provided by USDA and NRCS.

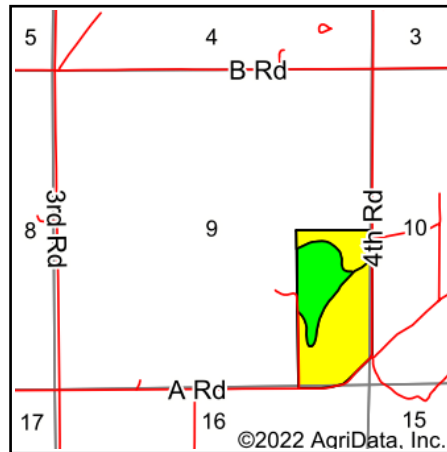

State: **Nebraska**  
 County: **Merrick**  
 Location: **9-11N-8W**  
 Township: **Vieregg**  
 Acres: **70.41**  
 Date: **9/21/2022**



Maps Provided By:  
  
 CUSTOMIZED ONLINE MAPPING  
 © AgriData, Inc. 2021 [www.AgriDataInc.com](http://www.AgriDataInc.com)



Area Symbol: NE121, Soil Area Version: 21

Code	Soil Description	Acres	Percent of field	SRPG Legend	Non-Irr Class *c	Irr Class *c	SRPG	Alfalfa hay Tons	Alfalfa hay Irrigated Tons	Corn Bu	Corn Irrigated Bu	Grain sorghum Bu	Grain sorghum Irrigated Bu	Soybeans Irrigated Bu	Winter wheat Bu	*n NCCPI Soybeans
8520	Merrick loam, rarely flooded	38.95	55.3%		I	I	78	5	6	70	160	80	130	48	42	77
6352	Leshara silt loam, occasionally flooded	20.19	28.7%		IIw	IIw	65	4	6	74	142	81	119	38	34	65
8503	Lex loam, occasionally flooded	11.27	16.0%		IIIw	IIIw	38	3	6	64	148	74	114	39	32	27
<b>Weighted Average</b>					<b>1.61</b>	<b>1.61</b>	<b>67.9</b>	<b>4.4</b>	<b>6</b>	<b>70.2</b>	<b>152.9</b>	<b>79.3</b>	<b>124.3</b>	<b>43.7</b>	<b>38.1</b>	<b>*n 65.6</b>

\*n: The aggregation method is "Weighted Average using all components"

\*c: Using Capabilities Class Dominant Condition Aggregation Method

Soils data provided by USDA and NRCS.