

Soils Map

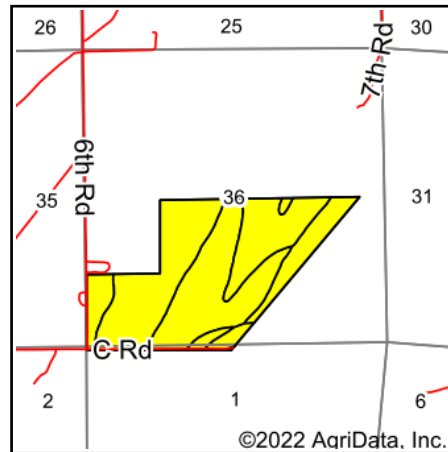

State: **Nebraska**
 County: **Merrick**
 Location: **36-12N-8W**
 Township: **Vieregg**
 Acres: **187.93**
 Date: **11/1/2022**

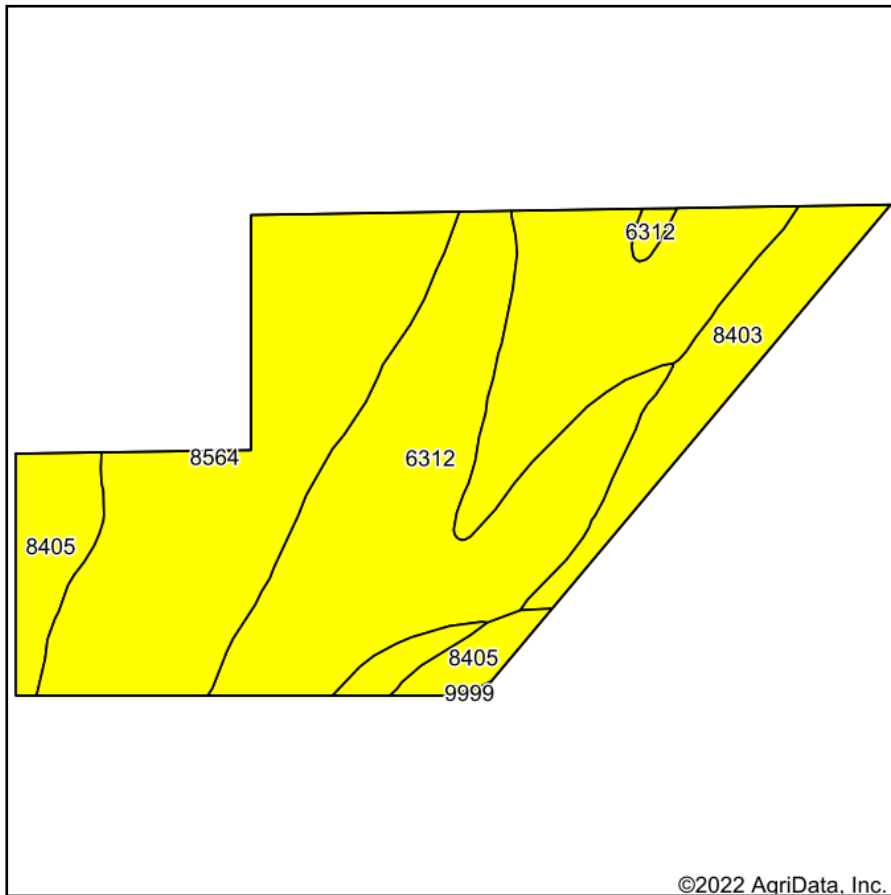

Maps Provided By:



Soils data provided by USDA and NRCS.

Area Symbol: NE121, Soil Area Version: 21

Code	Soil Description	Acres	Percent of field	SRPG Legend	Non-Irr Class *c	Irr Class *c	SRPG	Alfalfa hay Tons	Alfalfa hay Irrigated Tons	Corn Bu	Corn Irrigated Bu	Grain sorghum Bu	Grain sorghum Irrigated Bu	Soybeans Irrigated Bu	Winter wheat Bu	*n NCCPI Soybeans
8564	Platte loam, wet, occasionally flooded	94.13	50.1%		IVw	IVw	27				88		75			10
6312	Barney loam, frequently flooded	61.23	32.6%		Vw		25									12
8403	Alda loam, occasionally flooded	18.23	9.7%		IIIw	IIIw	33	3	5	61	142	69	114	37	31	23
8405	Alda sandy loam, occasionally flooded	14.21	7.6%		IIIw	IIIw	28	3	5	55	137	59	109	34	30	34
9999	Water	0.13	0.1%				0									
Weighted Average					*-	*-	27	0.5	0.9	10.1	68.2	11.2	56.9	6.2	5.3	*n 13.7

*n: The aggregation method is "Weighted Average using all components"

*c: Using Capabilities Class Dominant Condition Aggregation Method

*- Non Irr Class weighted average cannot be calculated on the current soils data due to missing data.

*- Irr Class weighted average cannot be calculated on the current soils data due to missing data.

Soils data provided by USDA and NRCS.