

Soils Map

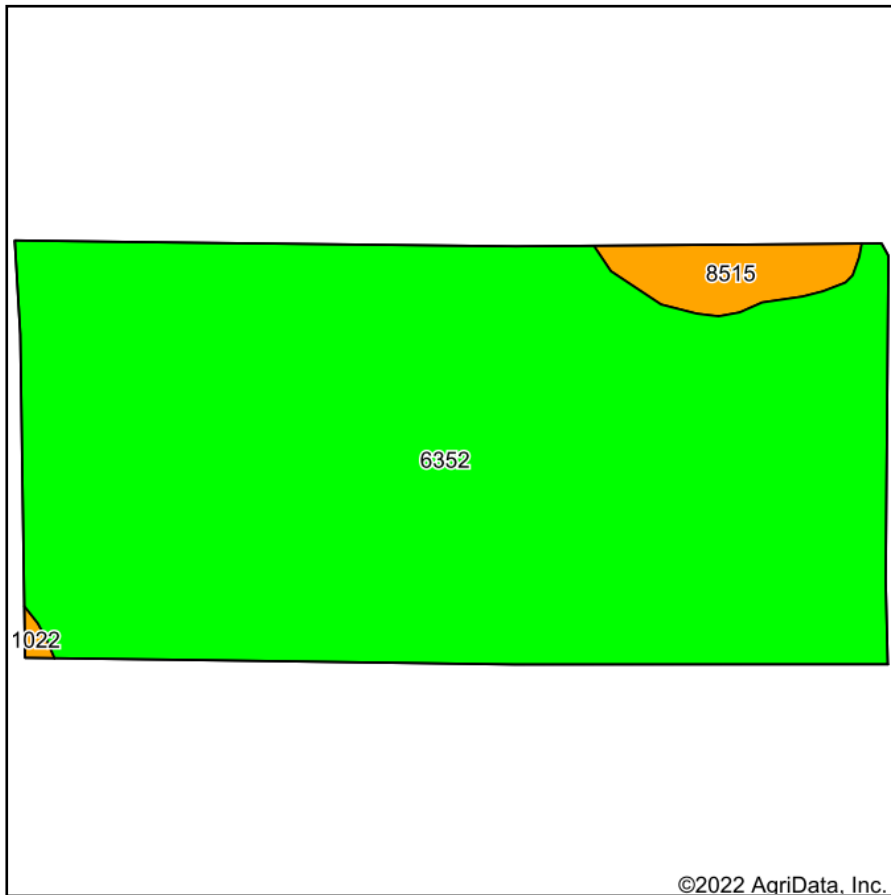

Soils data provided by USDA and NRCS.

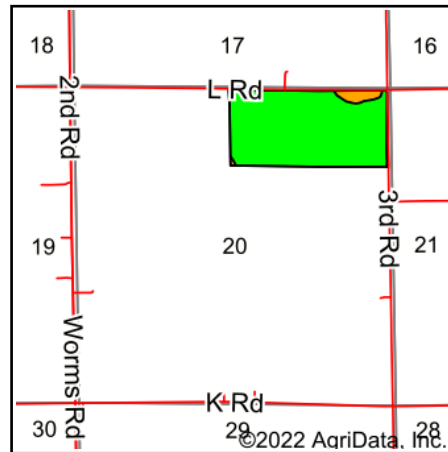

State: **Nebraska**
 County: **Merrick**
 Location: **20-13N-8W**
 Township: **Prairie Creek**
 Acres: **76.27**
 Date: **10/31/2022**



Maps Provided By:

 CUSTOMIZED ONLINE MAPPING
 © AgriData, Inc. 2021 www.AgriDataInc.com



Area Symbol: NE121, Soil Area Version: 21

Code	Soil Description	Acres	Percent of field	SRPG Legend	Non-Irr Class *c	Irr Class *c	SRPG	Alfalfa hay Tons	Alfalfa hay Irrigated Tons	Corn Bu	Corn Irrigated Bu	Grain sorghum Bu	Grain sorghum Irrigated Bu	Soybeans Irrigated Bu	Winter wheat Bu	*n NCCPI Soybeans
6352	Leshara silt loam, occasionally flooded	73.20	96.0%		IIw	IIw	65	4	6	74	142	81	119	38	34	65
8515	Lockton loam, rarely flooded	2.89	3.8%		IIIw	IIIw	56	2	5	48	149	70	120	40	33	36
1022	Caruso-Gayville complex, 0 to 1 percent slopes	0.18	0.2%		IIw	IIw	53	3	4	45	104	30	89	26	28	50
Weighted Average							64.6	3.9	6	72.9	142.2	80.5	119	38	33.9	*n 63.9

*n: The aggregation method is "Weighted Average using all components"

*c: Using Capabilities Class Dominant Condition Aggregation Method

Soils data provided by USDA and NRCS.