

Soils Map

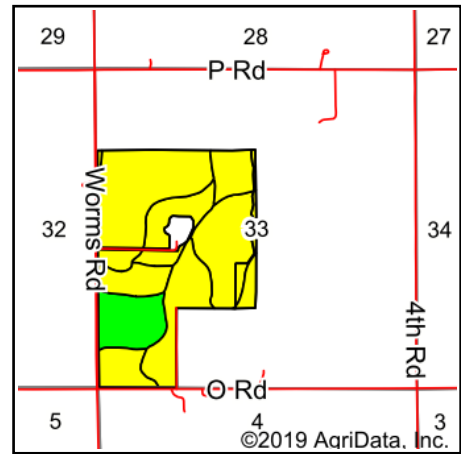

State: **Nebraska**
 County: **Merrick**
 Location: **33-14N-8W**
 Township: **Prairie Creek**
 Acres: **190.53**
 Date: **7/18/2019**

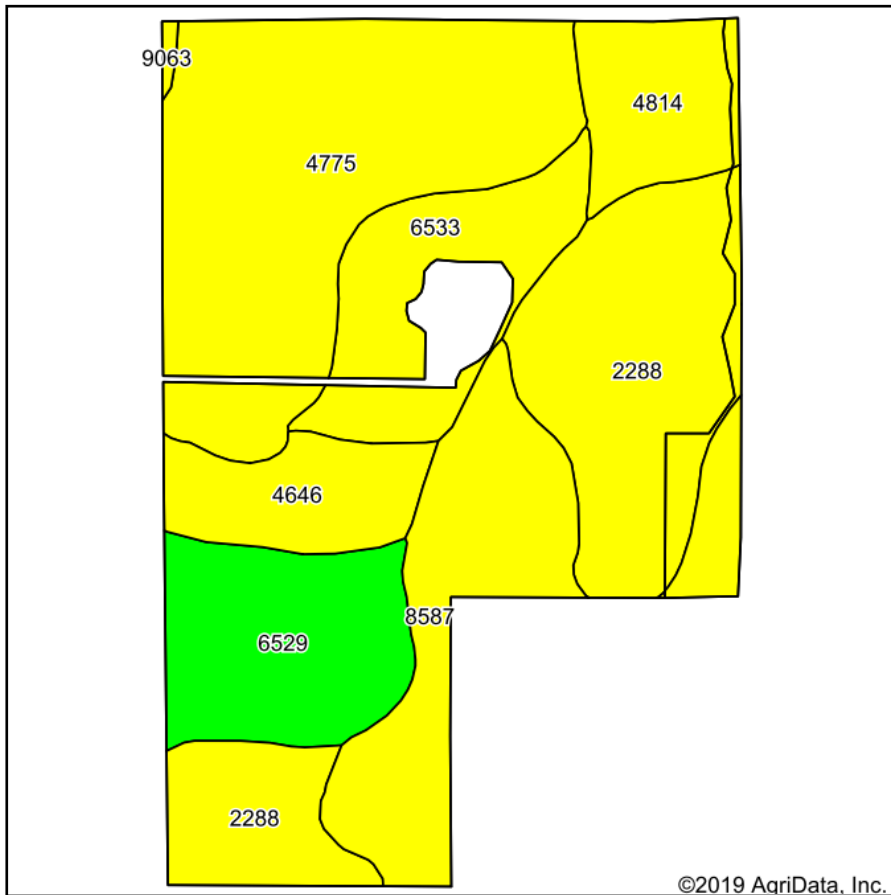

Maps Provided By:

 © AgriData, Inc. 2019 www.AgriDataInc.com



Soils data provided by USDA and NRCS.

©2019 AgriData, Inc.

Area Symbol: NE121. Soil Area Version: 18																
Code	Soil Description	Acres	Percent of field	SRPG Legend	Non-Irr Class *c	Irr Class *c	SRPG	Alfalfa hay	Alfalfa hay irrigated	Corn	Corn Irrigated	Grain sorghum	Grain sorghum Irrigated	Soybeans Irrigated	Winter wheat	*n NCCPI Soybeans
4775	Valentine and Thurman soils, 0 to 17 percent slopes	53.02	27.8%		Vle		27									23
2288	Wann loam, occasionally flooded	43.95	23.1%		llw	llw	49	4	6	64	148	87	114	38	37	47
8587	Wann sandy loam, occasionally flooded	29.12	15.3%		llw	llw	42	4	6	67	142	84	109	36	35	42
6529	Janude sandy loam, very rarely flooded	21.96	11.5%		lle	lle	66	3	6	75	154	75	120	42	33	54
6533	Loretto fine sandy loam, 0 to 2 percent slopes	17.64	9.3%		lle	lle	73	3	6	58	146	65	112	42	35	61
4646	lpage loamy fine sand, 0 to 3 percent slopes	12.20	6.4%		IVe	IVe	30	3	5	30	132	43	90		24	25
4814	Valentine loamy fine sand, 0 to 3 percent slopes	12.20	6.4%		IVe	IVe	29	2	4		110	30	100		19	25
9063	Kenesaw silt loam, 0 to 1 percent slopes	0.44	0.2%		llc	le	72									74
Weighted Average							43.5	2.5	4.1	40.9	102.6	52.2	79.3	23	23.7	*n 38.9

*n: The aggregation method is "Weighted Average using major components"

*c: Using Capabilities Class Dominant Condition Aggregation Method

Soils data provided by USDA and NRCS.