

Soils Map

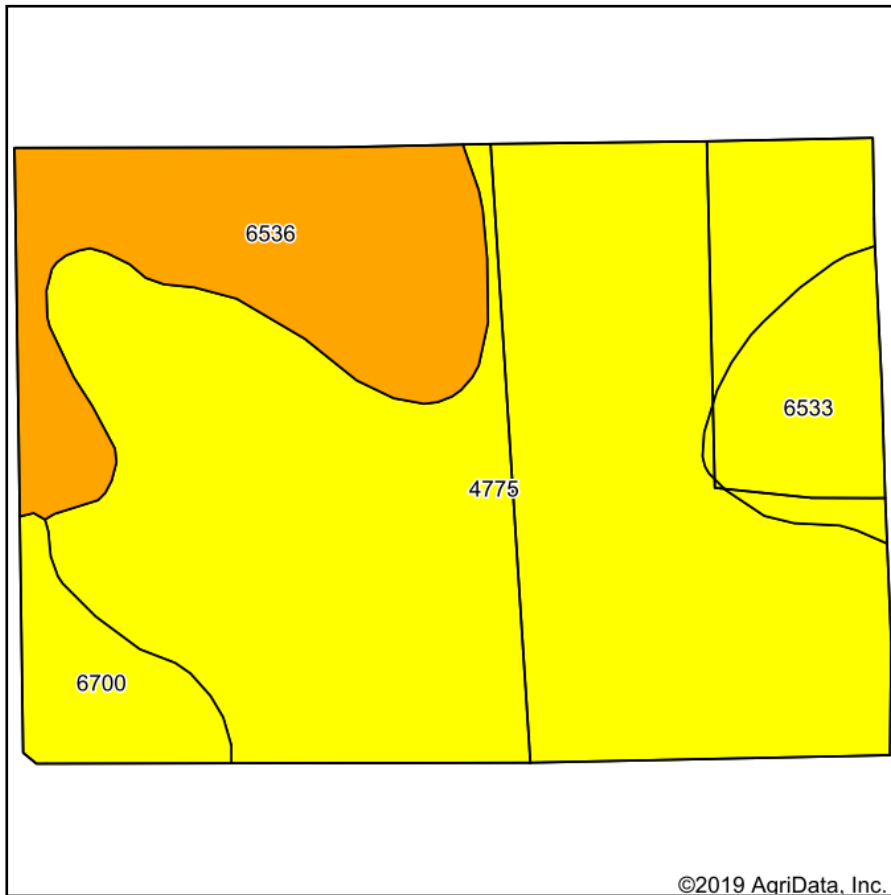

Soils data provided by USDA and NRCS.

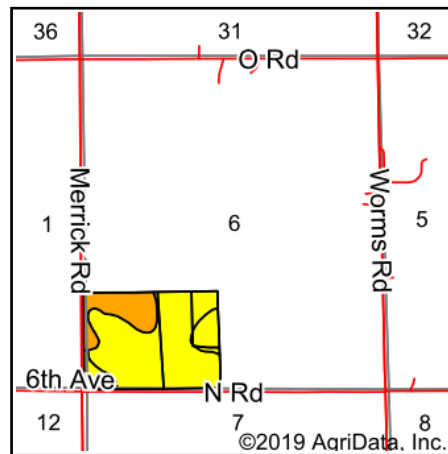

State: **Nebraska**
 County: **Merrick**
 Location: **6-13N-8W**
 Township: **Prairie Creek**
 Acres: **76.12**
 Date: **12/17/2019**



Maps Provided By:



Area Symbol: NE121, Soil Area Version: 19																
Code	Soil Description	Acres	Percent of field	SRPG Legend	Non-Irr Class *c	Irr Class *c	SRPG	Alfalfa hay	Alfalfa hay Irrigated	Corn	Corn Irrigated	Grain sorghum	Grain sorghum Irrigated	Soybeans Irrigated	Winter wheat	*n NCCPI Soybeans
4775	Valentine and Thurman soils, 0 to 17 percent slopes	53.00	69.6%		Vle		27									23
6536	Loretto-Valentine complex, 3 to 11 percent slopes	13.76	18.1%		IVe	IVe	51	2	5	50	127	40	105	32	25	46
6533	Loretto fine sandy loam, 0 to 2 percent slopes	5.32	7.0%		Ile	Ile	73	3	6	58	146	65	112	42	35	61
6700	Thurman loamy fine sand, 0 to 2 percent slopes	4.04	5.3%		IIle	IIle	34	2	4	40	121	42	105		18	31
Weighted Average							34.9	0.7	1.5	15.2	39.6	14	32.4	8.7	7.9	*n 30.2

*n: The aggregation method is "Weighted Average using major components"

*c: Using Capabilities Class Dominant Condition Aggregation Method

Soils data provided by USDA and NRCS.